

Typical Section



Ingenium, Inc.™

4085 Devereux Chase  
Roswell, GA 30075  
678.315.1751

Scale: NTS

Date: 6/26/2024

Project:

Conceptual Bulkhead Design  
FRP Wale & Earth Anchor

Sheet 1 of 2

Conceptual Bulkhead  
Design  
Not for Construction

Certified only with seal, signature, and date

**NOTE:**  
 Noted variables in design are to be decided on by a local, registered engineer.

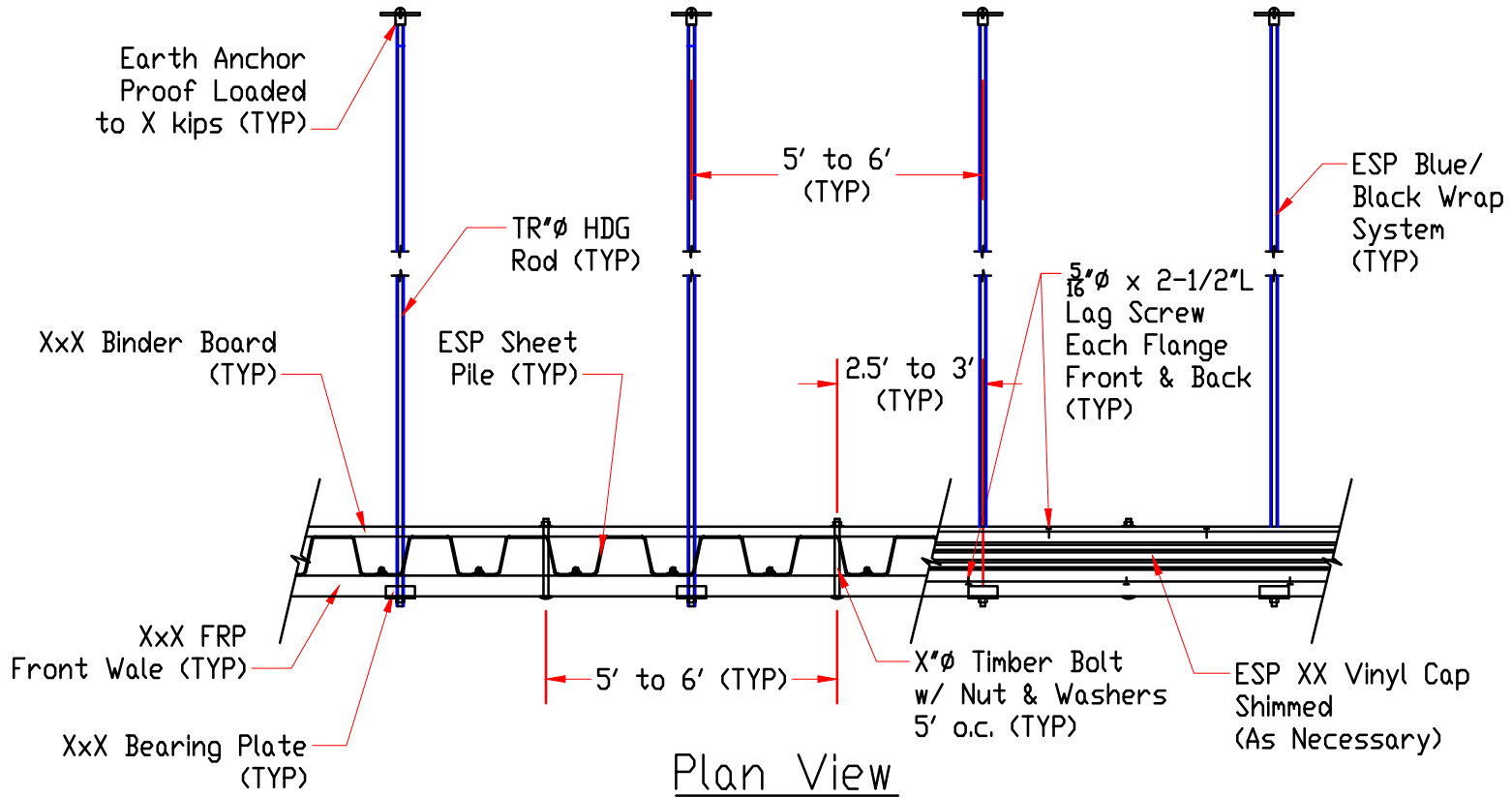

 **Ingenium, Inc.**<sup>TM</sup>  
 4085 Devereux Chase  
 Roswell, GA 30075  
 678.315.1751

Scale: NTS

Date: 6/26/2024

Project:  
 Conceptual Bulkhead Design  
 FRP Wale & Earth Anchor



Sheet 2 of 2

**Conceptual Bulkhead Design**  
Not for Construction

Certified only with seal, signature, and date