

**EverComp 100.5™  
FRP Sheet Pile**

**The strongest, toughest  
and most durable synthetic  
sheet pile in the world**

**Technical Data Sheet**

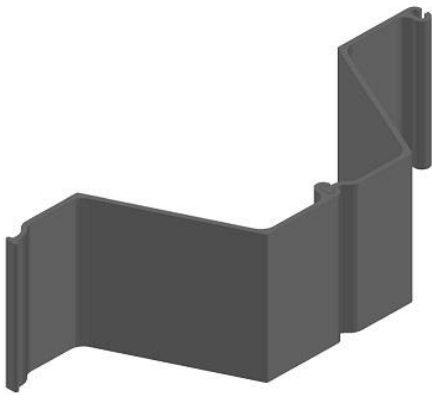
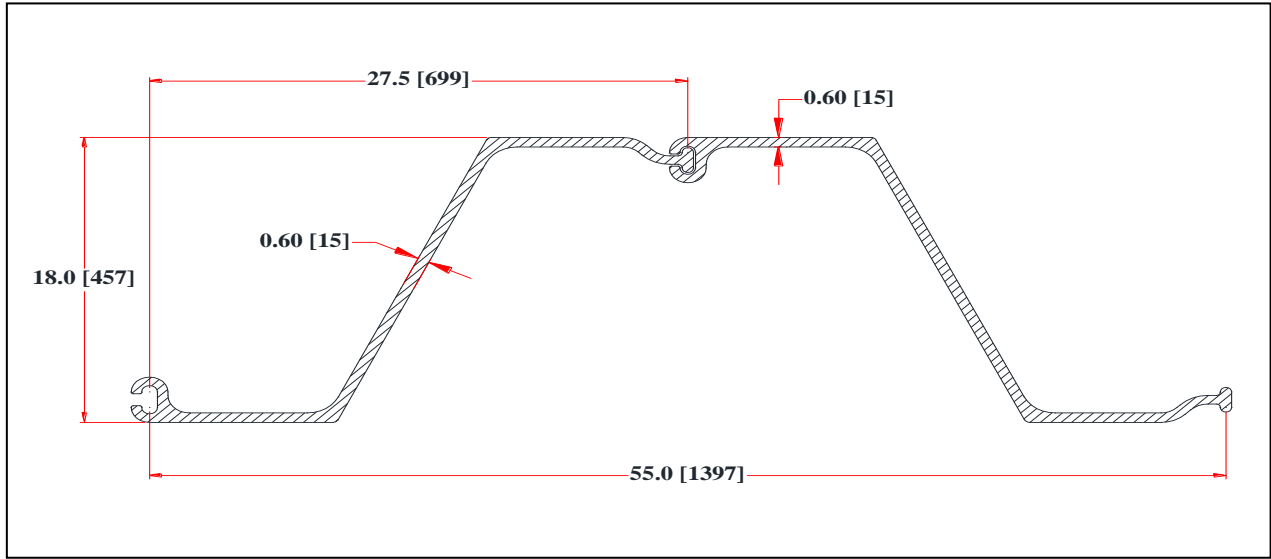

*The latest offering in the EverComp series, the EC 100.5, is aimed to take on heavy seawall and bulkhead projects, as well as tougher driving episodes.*

<i>Properties of Sheet Pile:</i>				
Width	W	in	27.5	-----
Depth	D	in	18.0	-----
Thickness	t	in	0.60	-----
Section Modulus	Z	in <sup>3</sup> /ft	67	-----
Moment of Inertia*	I	in <sup>4</sup> /ft	602	-----
Radius of Gyration (pair)	r	in	7.13	-----
Area of Web	A <sub>w</sub>	in <sup>2</sup>	11.5	-----

\*Note: Deflection should be limited and usually controls the design. Maximum deflection to be determined by the project's engineer. ESP recommends that max. deflection should be less than 2% of the span e.g. distance from lowest wale support to ground line.

The values shown are averages and may vary. No warranties of any kind are made as to the suitability of ESP sheet piling for particular applications



**Everlast Synthetic Products, LLC**  
 1000 Wyngate Pkwy, S-100  
 Woodstock, GA 30189  
 800-687-0036  
 800-687-0048 fax  
[www.everlastseawalls.com](http://www.everlastseawalls.com)